

Partition panels

MODULAR PARTITION PANEL

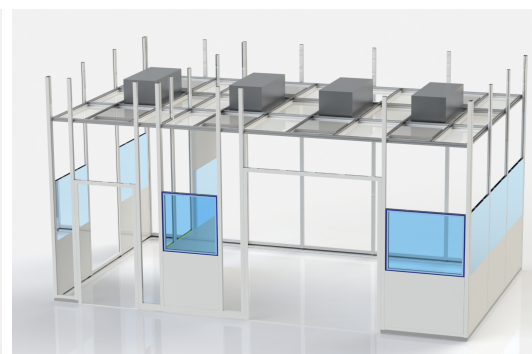
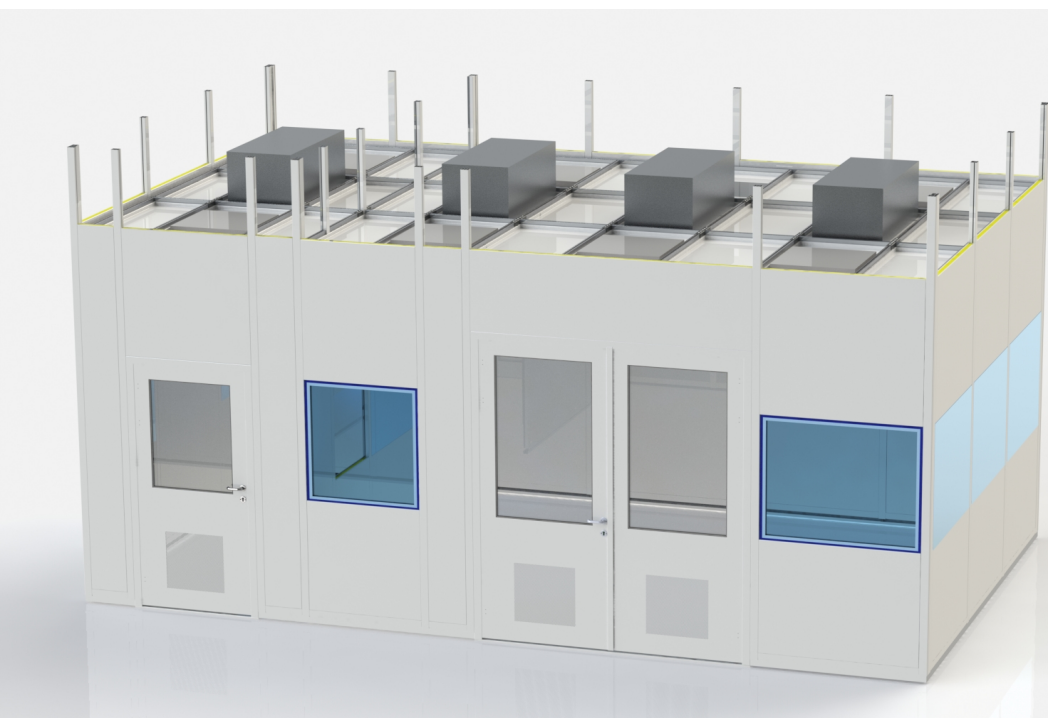

DEVICE DESCRIPTION

- The whole system is self-supporting – it does not need anchoring in walls and in ceiling.
- Dimensions of the module: 6.5 m x 1.25 m, maximum height: 4 m.
- Any number of the modules may be assembled side by side in both directions.
- Air circulation is provided by FFU units; the module does not need any connection to a central HVAC system.

PARTITION WALL SYSTEM

- The support system consists of aluminium profiles and of sandwich-type panels.
- The panels are anchored in the aluminium support profiles. Joints are blinded by covers.
- The aluminium profiles and panels establish a flat plain, thus preventing it from occurrence of non-cleanable spots.
- Inside a partition wall is a sufficient space for distribution of media and electric energy distribution.

CEILING

- Consists of an aluminium grid and of embedded, single-case panels.
- The panels and the grid establish a flat plain, thus providing it from occurrence of non-cleanable spots.
- Into the soffit may be inserted integrated lighting units and openings for sprinkler heads may be made.

- In the walkable variant the soffit features the surface load capacity 75 kg/m² and the random load capacity 150 kg.

ADVANTAGES

- Simple dismantling and interchangeable parts.
- Any time when necessary, this enables:
 1. Simple integration of technologies, cabinets, and of other elements,
 2. Simple layout change of a clean room.
- Meets high demands on hygienic harmlessness, simple cleaning, and disinfecting.
- Simple and rapid assembly.
- Wide scale of colour and material layouts.

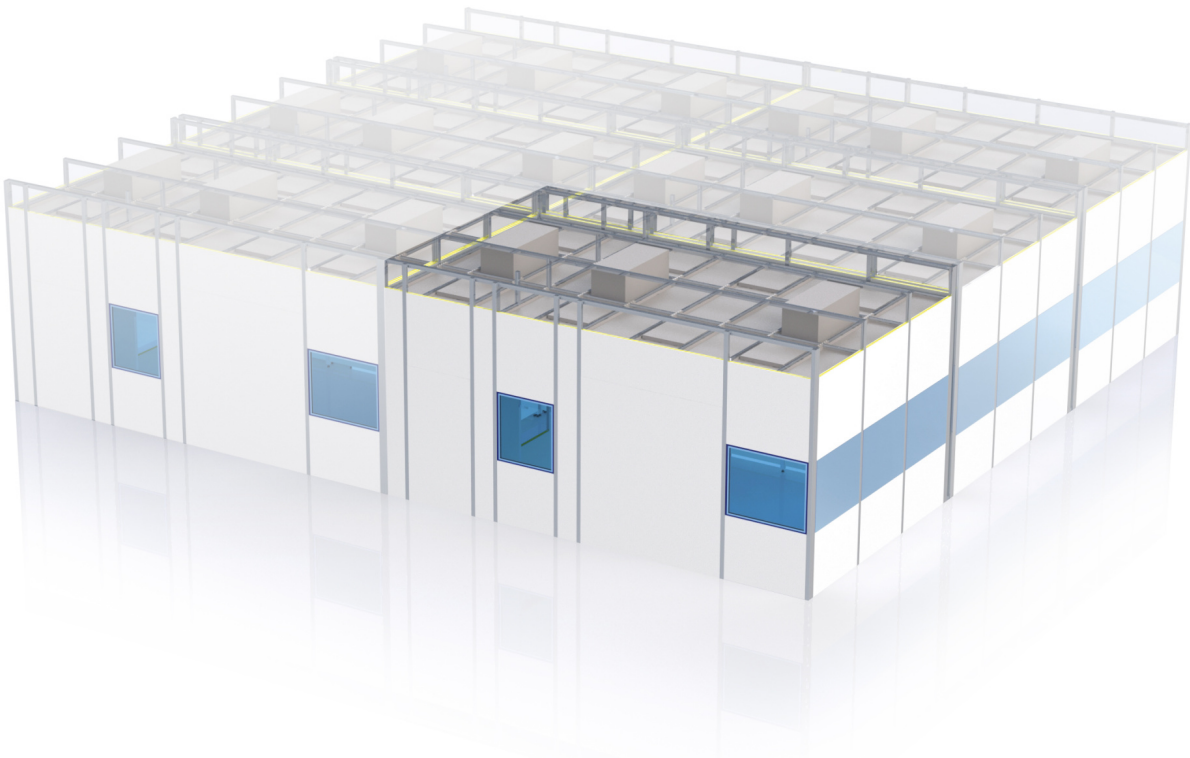

TECHNICAL DATA

Panel type

modular partition panel

Panel width

1190 mm

atypical

W - width in mm according to dimensional range 560 mm, 1190 mm. It is possible to order atypical panel dimensions: min. dimension 300 mm, max. dimension 1190 mm.nal range 560 mm, 1190 mm.

Panel height H

2550 mm

2750 mm

3050 mm

atypical

Height according to standard dimensional range 2550, 2750, 3050 mm. Preferred dimensions 2550, 2750, 3050 mm. Min. dimension 300 mm, max. dimension 4000 mm.

Side end

lined

atypical

The side end of the panels is always with the rim that is part of the anchorage to the raster.

Bottom end

end for BASIC profile

straight

atypical

The panel that abuts the Basic profile has reinforcement and a turned U-profile. The others are the bottom end always straight.

Upper end

straight

atypical

Mounting in the Basic profile allows us to extend the floor surface layer onto the partitions.

Number of cable glands

2 pcs (1 pc 85 mm from the left- 1 pc 85 mm from the right)

no cable gland

cable glands from the left, cable glands from the right

Thickness of metal sheet

light version (galvanized metal sheet 0,7 mm)

heavy option (galvanized metal sheet 1,2 mm)

atypical

Filler

mineral wool (100 kg/m³)

mineral wool (150 kg/m³)

atypical

Facing hue and material - standard on the visible side

Galvanized metal sheet, hue RAL 9016

Stainless steel AISI 304

Powder coating (Komaxit), hue RAL

Facing hue and material - standard on the back side

Galvanized metal sheet, hue RAL 9016

Stainless steel AISI 304

Powder coating (Komaxit), hue RAL

Atypical design

Type design

Atypical design

Type design

0 - Unique specification out of offered versions

Atypical design

Q - atypical design that cannot be uniquely specified by a code

MORE INFORMATION, PHOTOS

